

*Peace at ease*

LOGO



PROPOSED RESIDENTIAL  
APARTMENTS @ CHETIPEDU  
FOR M/S BASS PROPERTIES PVT. LTD.

Architects & Interior Designers:

M. IBRAHIM M. Arch (RED), AIA.

RAYAN IBRAHIM ARCHITECTS (P) LTD

Reheja towers, Omega wing, 3rd floor,

#177, Anna Salai, Chennai-600002.

Mobile: 9500084312, Ph:044-4305 04050

website: www.rayanarchitect.com

## Pacific Profile

Pacific Builders since inception in 1994, we have remained committed to customer service and to provide our customers a worry-free living experience. Now a brand name signifying high quality, exceptional service and superior value. To observe high standards of business and personal ethics in the conduct of our duties and responsibilities have benchmarked our position in the industry and quickly built a reputation for integrity, teamwork and commitment. These values remain true today and stand testimony to our decadal growth with an outstanding number of complacent clientele. This is a milestone which all of us accept with pride. Customers are the most important assets, having said this; we incorporate a blend of dedication, attitude, design and operational feasibilities contributing immense pleasure and strongly believe to have touched the hearts of individuals throughout. Our core competencies include construction, design, maintenance, project management, and safety. No wonder, our customers count on us to deliver quality projects, now and always.

### PACIFIC VISION

We are devoted to our commitment to excellence by striving hard to exceed customer expectations. We aspire to be recognized far and wide by our customers and associates for our standards, efficiency and ability.

### DIRECTOR'S DESK:

Right from the inception, we have strongly adopted innovative methods and conceptual cost estimations to ensure costefficient projects. One of our core features is our intact budgetplanning through which we mobilize funds through private investors rather than acquiring loans from financial institutions& this has enabled us to offer all our projects at an affordable price to our customers. The entire regime has been built through referrals and stands reason as to why we spend a meager amount on promotional activities. The entire thing sums up to the financial benefit us, that we delightedly share with our customers in terms of affordability. I personally feel that our reasonable profit margins, a phenomenal eye to quality, professional expertise and high ethical business practices have established us for what we are now.

### PACIFIC TEAM :

A highly proficient team & a highly enterprising unit is a rare combination. Our team is one such. It is accelerated by a sense of pride and commitment to excellence that guarantees success. The team is well equipped operating in a technically advanced work environment and are innovative with inquisitiveness for challenges and greater opportunities. On a whole the team substantiates the excellent reputation that the company has earned for years.

## Conpro Profile

Conpro is a brainchild of a group of qualified, talented and experienced entrepreneurs driven by core values of Islamic Sharia. We are a committed team of Engineers and Architecture professionals who have formed this company to provide high quality Projects in India and Overseas.

A Core Team of Senior Executives, with more than 20 years of individual multi-facet Core Values

- Commitment to our valued clients.
- Uncompromised quality standards.
- Professionally managed team that employs modern construction techniques and quality control systems with international safety standards.
- Every project will be given total care from conception to successful completion.

### VISION

To Be A Significant Contributor In The Real Estate Development And Construction Business To Enrich Life And Prosper.

### MISSION

Providing Quality Construction In A Timely Manner And Strive To Achieve The Highest Level Of Customer Satisfaction By Honest Means And Service.

### QUALITY

- **Reliability:** We provide and deliver precision services-timely.
- **Co-operation:** We want to grow with our employees & associates.
- **Innovation:** We stay one step ahead...always!
- **Environment Technology:** We care and protect our environment.
- **Trust:** We believe in customer satisfaction.
- **Safety:** All the above is possible only if SAFE working practices are adopted.



2BHK

Area: 891 sqft



3BHK

Area: 1312 sqft



3BHK

Area: 1312 sqft

PLAN 1



2BHK

Area: 891 sqft



2BHK

Area: 826 sqft



2BHK

Area: 876 sqft

THERE IS NOTHING LIKE  
**STAYING**  
AT HOME FOR REAL  
**COMFORT**

BAAS properties - Company established by eminent personalities from PACIFIC BUILDERS PVT. Ltd., and CONPRO PROPERTIES. Now Coming out with new project BAAS - ACUIR, a multistorey apartment at chettipedu, In total 96 homes with a mix of 2BHK & 3BHK apartments with adequate covered Parking for everyone



2BHK

Area: 891 sqft



3BHK

Area: 1312 sqft



3BHK

Area: 1312 sqft

PLAN 2



2BHK

Area: 891 sqft

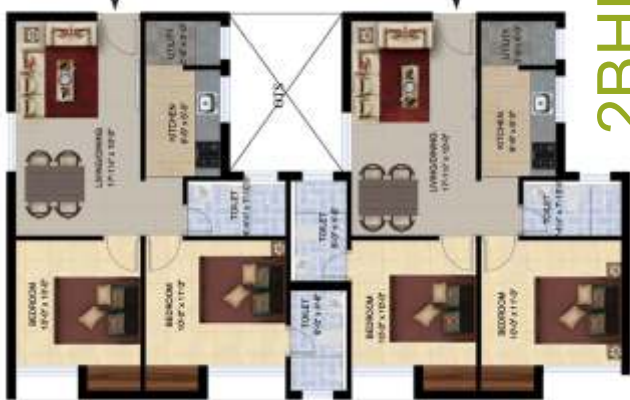

2BHK

Area: 826 sqft



2BHK

Area: 876 sqft

THERE IS NOTHING LIKE  
**STAYING**  
AT HOME FOR REAL  
**COMFORT**

BAAS properties - Company established by eminent personalities from PACIFIC BUILDERS PVT. Ltd., and CONPRO PROPERTIES. Now Coming out with new project BAAS - ACUIR, a multistorey apartment at chettipedu, In total 96 homes with a mix of 2BHK & 3BHK apartments with adequate covered Parking for everyone



## BAAS PROPERTIES LTD

G 2 Block B, Ameen Manors,  
No. 138, Nungambakkam High Road,  
Chennai - 600 034.

M: 8939895083,8939895082,9790943356

T:

E: [baasproperties@gmail.com](mailto:baasproperties@gmail.com)

www. \_\_\_\_\_



# Specifications

## STRUCTURE

- RCC Framed Structure
- Brick Work and Plastering

## JOINERIES:

- Main Door - Teak wood Frame with Solid Teak Door
- Bedroom Doors - Teak wood Frame With BSC Flush Door with Cylindrical Lock
- Toilet Doors - Teak wood Frame with water pined plastic coated Rush doors
- Balcony Doors - Teak wood Frame water proof plastic coated flush doors
- Windows - Teak wood Frame and Shutters with Grills
- Wooden Ventilators

## FLOORING:

- Vitrified Tiles ( 2'0 x 2'0)
- Bed Room & Kitchen - Vitrified Tiles (2' x 2')
- Balcony & Service - Vitrified Tiles (12" x12")
- A. Toilet Floor - Anti Skid tiles (12" x 12")
- Toilet Dado - Glazed Tiles up to 7'0' height
- Common Area - porcelain tiles
- Staircase – Granite
- Car Park - FCC / Granolithic Flooring

## STAIRCASE RAILING:

- Steel Handrail with Grill

## COUNTER TOP:

- 20mm Granite in Kitchen Counter with 2'0' tile above
- Stainless Steel Sink

## PLUMBING & SANITARY:

- Concealed PVC Pipes /G I Pipes for Bath Rooms - ISI Make
- Separate Motors for Sump and Bore well - 1 Hp Motor
- Sanitary fittings - Hind ware / Herm / equivalent - White Color

## ELECTRICAL:

- PVC Pipes - Adhering to ISI Standards
- Copper Wires - Adhering to ISI Standards
- Switches - Modular Type

## LIFT:

- 6 passengers Johnson Lift - Evergreen Model

## PAINTING & POLISHING:

- Internal - Living, dining and bedrooms –Two coat Patty with Emulsion Paint Finishing
- External - Exterior Emulsion Paint
- Wood Works / Grills Enamel Paint
- Main door - Melamine Polish

## Special Features - Pacific City

- Fully Equipped Gym
- Club House
- Steam bath
- Jacuzzi
- Swimming Pool
- Power Back Up Generator
- Children Play Area
- Water Treatment Plant
- Sewage Treatment Plant
- Vitrified Tiles

